

Wastewater

ESP33 Series



Applications

- Ideal for basement sump or for pumping liquid effluent.

Features

- 1/3 hp 115 Volt thermal overload protected, continuous duty "oil free" motor. Stainless steel heat treated shaft, upper and lower permanently lubricated ball bearings. 5.6 full load Amps
- Rugged cast iron motor housing dissipates heat away from motor. Cast iron pump casing. Models ending in -P have thermoplastic motor cover and casing
- 5 vane reinforced polypropylene impeller handles 1/2" spherical solids - with brass insert
- 1 1/2" NPT discharge. Reducer bushing for 1 1/4" discharge included
- 1/2" solids handling capability
- Permanently lubricated double lip seal
- Automatic with piggyback mechanical float switch or vertical float switch. Also available in manual operation
- 10' power cord

LittleGIANT®

Engineering Data

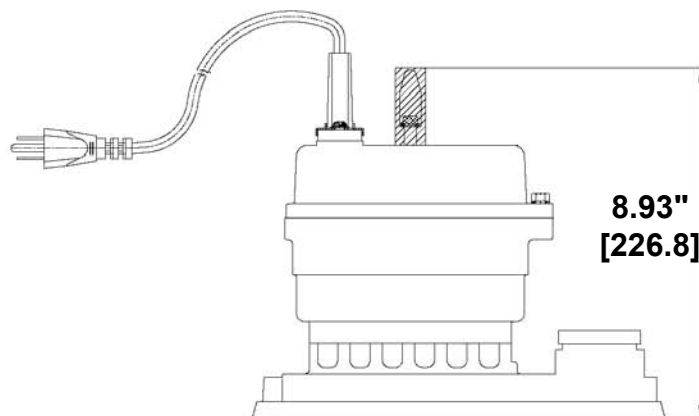
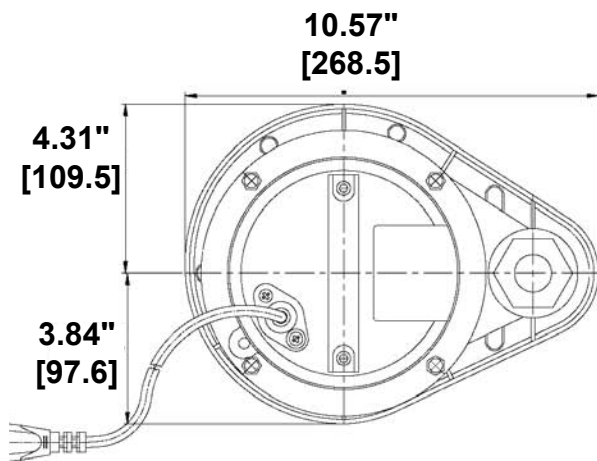

*Dimensions measured in inches [mm]

Specifications

Item No.	Model No.	Listing	HP	SFA	Volts	Discharge	Switch Type	Performance (gpm @ head)			Shut-Off Head (ft)	Cord Length (ft)	Ship Wt. (lbs)
								5'	10'	15'			
620186	ESP33AM	cCSAus	1/3	5.6	115	1-½ - 1-¼	Piggyback Mechanical Float	44	33	13	17.5	10	20
620185	ESP33AM-P	cCSAus	1/3	5.6	115	1-½ - 1-¼	Piggyback Mechanical Float	44	33	13	17.5	10	19
620120	ESP33AV	cCSAus	1/3	5.6	115	1-½ - 1-¼	Vertical Float	44	33	13	17.5	10	20
620089	ESP33M	cCSAus	1/3	5.6	115	1-½ - 1-¼	Manual	44	33	13	17.5	10	17
620121	ESP33AV-P	cCSAus	1/3	5.6	115	1-½ - 1-¼	Vertical Float	44	33	13	17.5	10	19

Performance Data

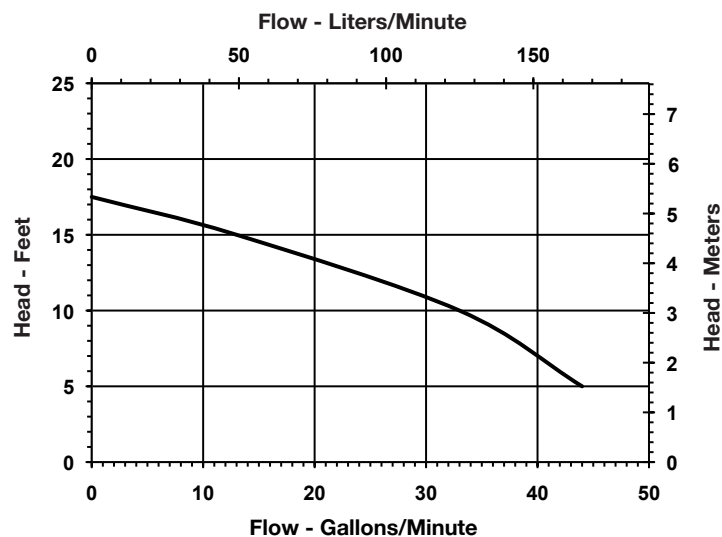

Franklin Electric

P.O. Box 12010
Oklahoma City, OK 73157-2010
Phone: 1.800.701.7894
Fax: 1.800.678.7867
www.LittleGiantPump.com



©2011 Franklin Electric Co., Inc.
Little Giant® is a registered trademark of Franklin Electric Co., Inc.
Form 996167 — 05/11